

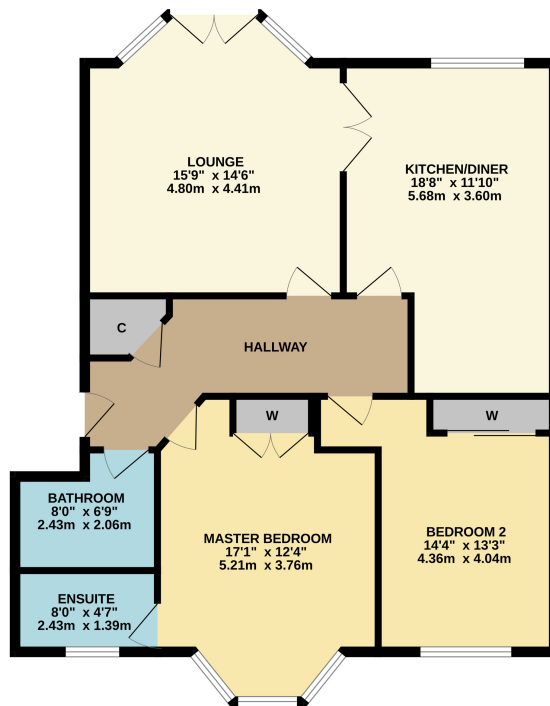

G/L, 76 Oakburn Walk, Jamestown, G83 9NJ

We are delighted to present to the market this larger style two bedroom ground floor apartment which is located in this extremely popular development built by the renowned Turnberry Homes.

GROUND FLOOR  
942 sq.ft. (87.5 sq.m.) approx.



MODERN 2 BED GROUND FLOOR APARTMENT

TOTAL FLOOR AREA: 942 sq.ft. (87.5 sq.m.) approx.

Whilst every attempt has been made to ensure the accuracy of the floorplan contained here, measurements of doors, windows, rooms and any other items are approximate and no responsibility is taken for any error, omission or mis-statement. This plan is for illustrative purposes only and should be used as such by any prospective purchaser. The services, systems and appliances shown have not been tested and no guarantee as to their operability or efficiency can be given.  
Made with Metropix C2024



David Muir Estate Agents  
2 Church Street, Dumbarton,  
G82 1QL

Tel 01389 734366  
Fax 01389 742476

tracy@davidmuirestates.co.uk



#### **Travel Directions**

From Alexandria town centre over Bonhill Bridge continue to mini roundabout and take third exit into Oakburn Walk. First left and follow road. No 76 is on your left from this approach. The flat is located on the ground floor left hand door, secure door entry system in operation.

#### **Additional Information**

Home Report Valuation: £150,000  
Council Tax Band: D  
Energy Efficiency Rating: B  
Double Glazing  
Gas Central Heating

#### **Home Report**

This property benefits from a Home Report which can be obtained from [davidmuirestates.com](http://davidmuirestates.com) or [onesurvey.org](http://onesurvey.org)

#### **Disclaimer**

These property details are set out as a general outline only and do not constitute any part of an Offer or Contract. All fixtures and fittings mentioned in these particulars are included in the sale. All others in the property are specifically excluded. Photographs are reproduced for general information and it must not be inferred that any item is included for sale with the property. All measurements, distances and areas are approximate and for guidance only.